

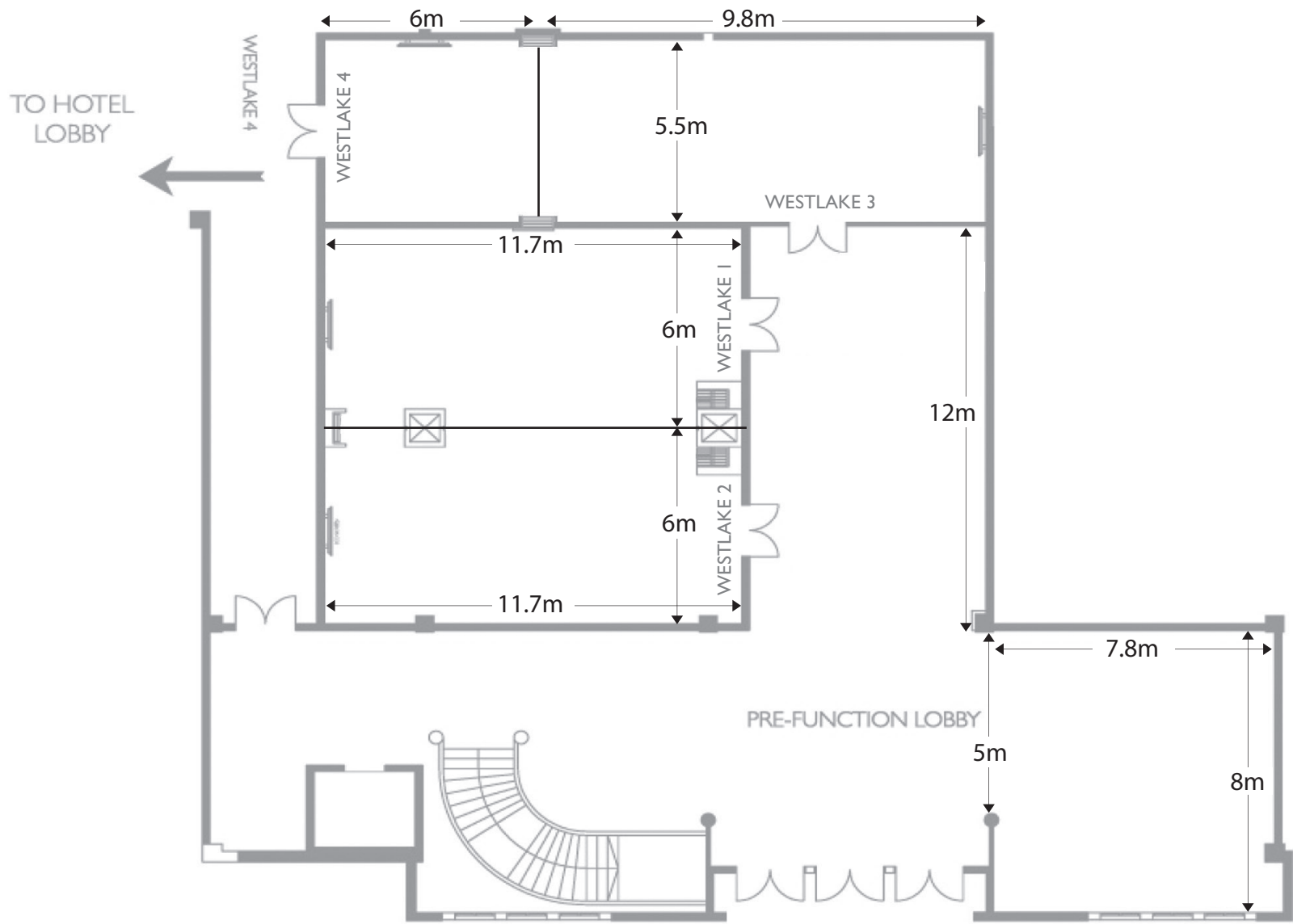

INTERCONTINENTAL  
HANOI WESTLAKE

CONVENTION ROOMS DIMENSIONS & CAPACITY

MEETING CENTRE	MEASUREMENT				CAPACITY					
	Sq-meter (m2)	Length (m)	Width (m)	Ceiling/Height	U shape	Theater Style	Classroom style	Hollow square	Cocktail party	Banq Sit down
<b>Grand Ballroom - 2nd Floor</b>										
<b>Grand Ballroom (1&amp; 2&amp; 3)</b>	364	23.4	15.4	5	57	420	220	66	450	288
Grand Ballroom (1 & 2& 3) with stage	364	23.4	15.4	5	57	380	220	No Stage	420	240
Ballroom 1	121.3	7.8	15.4	5	39	108	60	48	150	96
Ballroom 2	121.3	7.8	15.4	5	39	108	60	48	150	96
Ballroom 3	121.3	7.8	15.4	5	39	108	60	48	150	96
Ballroom 1 (2,3) with stage	121.3	7.8	15.4	5	39	96	60	No Stage	130	72
Ballroom 1 & 2 (2&3)	242.6	15.6	15.4	5	45	216	120	54	280	192
Ballroom 1&2 (2&3) with stage	242.6	15.6	15.4	5	45	200	120	No Stage	250	144
Ballroom Pre-function foyer	172	24	8.3	4	N/A	N/A	N/A	N/A	250	N/A
<b>Grand Ballroom total area</b>	<b>364 (m2)</b>									
<b>Grand Ballroom total area with foyer</b>	<b>536 ( m2)</b>									
<b>Westlake Meeting Rooms - 1st Floor</b>										
Westlake Meeting Room 1	66	11.7	6	2.65	21	45	24	30	40	30
Westlake Meeting Room 2	66	11.7	6	2.65	21	45	24	30	40	30
<b>Westlake Meeting Room 1&amp;2</b>	132	11.7	12	2.65	39	70	45	48	90	72
Westlake Meeting Room 3	54	9.8	5.5	2.65	21	50	24	24	40	20
Westlake Meeting Room 4	33	6	5.5	2.65	9	28	12	12	20	10
<b>Westlake Meeting Room 3&amp; 4</b>	87	15.8	5.5	2.65	27	70	45	36	70	40
Westlake pre-function foyer	77	6.6	12	2.65	N/A	N/A	N/A	N/A	200	N/A
<b>Westlake function room total area</b>	<b>219</b>				N/A	N/A	N/A	N/A	250	N/A
<b>MILAN - SAIGON RESTAURANT</b>	<b>CAPACITY</b>									
	<b>Existing</b>	<b>Banquet Sitdown</b>		<b>BQ Sitdown with Buffet</b>						
<b>Saigon Restaurant</b>	64	108		108						
<b>Milan Restaurant</b>	64	108		108						
<b>Milan - Saigon Restaurant</b>										



InterContinental Meeting Center - 1<sup>st</sup> Floor

INTERCONTINENTAL GRAND BALLROOM

